

SPECIFICATION SUBMITTAL SHEET

jones stephens corporation

SEWER POPPER™ CLEANOUT AND RELIEF VALVE

PART NO. S62-304

features and benefits:

- Automatic pop-up releases sewage overflow outside the house
- Prevents thousands of dollars in property damages
- Eliminates health hazards associated with sewage overflow
- Vandal- and tamper-resistant center
- Threaded for 3" or 4" pipe or tapped adapter
- Constructed of white PVC
- Threaded unit can be used with PVC or ABS tapped adapter
- For cast iron pipe, use standard no hub clamp
- Meets Southern Building Code Section 301.10, Principle No. 10
- Patent No. 5,209,257
- Meets ASTM Standard D-2665



A (OVERALL HEIGHT)

3 1/2"

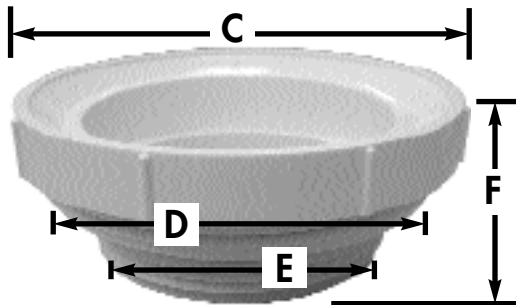

C (TOP DIMENSION)

5"

D (WIDTH OF THREADS)

4"

E (WIDTH OF THREADS)

3"

F (HEIGHT)

1 3/4"

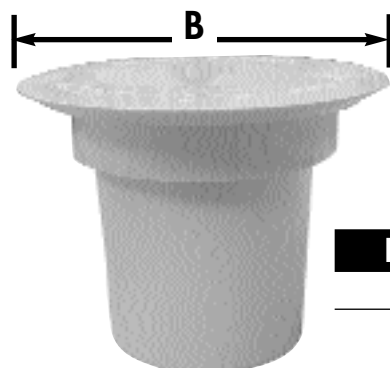

B (TOP OF POPPER)

4 5/8"

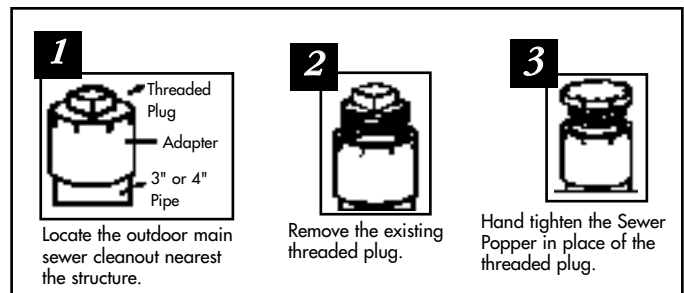

jones stephens corporation
3249 moody parkway • moody, alabama 35004
toll free phone: 1-800-355-6637 • toll free fax: 1-800-462-6991
www.plumbest.com